



# PLANNING *for* *our* FUTURE

**Neighborhood Outreach & Feedback  
May 19, 2016**

**[www.msdt.k12.in.us](http://www.msdt.k12.in.us)**

# Agenda for the Community Meeting

**Part 1:** Why do we need your feedback?



**Part 2:** Review of District Wide Outreach



**Part 3:** What does this mean for John Strange?



**Part 4:** Possible Solutions, Feedback, School Tour & Next Steps



# Why we need your feedback!





## Concern Heard in the Community:

*“The district is going to board up and close John Strange, and it will become an eyesore in the community.”*

## **Responses**

- None of the potential plans for John Strange include closure
- All potential plans involve the use of John Strange for delivery of educational services to students and use by our school community



**Concern Heard in the Community:**  
*“The district is trying to do this too fast and without looking at all options.”*

## **Responses**

- Any potential changes are at minimum 3 years away and will have input from the community
- WT conducts on-going Master Facility Planning
- The current Master Facility Committee spent the last year reviewing needs and solutions
- We have held community outreach efforts including 2 phone surveys, 2 online surveys, ongoing feedback cards and more than 70 community meetings



## Concern Heard in the Community:

*“Just open up Wyandotte in addition to keeping John Strange and Allisonville open.”*

### Responses

- A 9<sup>th</sup> elementary school would require an additional \$1-\$2 million annually in operating costs for staff from taxpayers
- The eastside needs increased space for students, but the district does not have the funds to sustain 3 elementary schools
- Operating and construction referendum amounts would significantly increase if opening a 3<sup>rd</sup> elementary school on the eastside

# **Community Outreach Review District Wide 2015-16**





# A Deliberative Process (Past 12 Months)



Commitment to Transparency



Community Surveys



Community Meetings



Tours of Facilities



Community-wide Newsletter



Social Media Posts



Meetings with Key  
Constituency Groups



Access to Board Members  
and Administrators



Community-Based Master  
Facilities Committee





# District Wide Issues & Potential Solutions

## Issues to Address:

- ✓ Most buildings are over fifty (50) years old and lack technology systems support
- ✓ All buildings 20-40 years since last major renovation
- ✓ Buildings lack security implementations found in many other school districts
- ✓ Elementary buildings are overcrowded to the point of impacting the educational process
- ✓ Maintain current staff while adding new staff to support opening of 8<sup>th</sup> elementary school

## Potential Solutions:

- ✓ Community financial investment in facility improvements, new facilities, security upgrades, staff and programs
- ✓ Sustainable construction designed to serve the needs of generations for decades
- ✓ Safety improvements will be a priority
- ✓ Remove trailers from our schools and reduce overcrowding
- ✓ Re-open closed elementary schools



## Things Made 50 Years Ago (when Washington Township Schools were built)





## Current Washington Township School Conditions



Systems at the end of their Useful Life



Make Shift Classrooms



Trailer Classrooms



Outdated Learning Environments



Overcrowded Spaces



Lack of Instructional Storage



## Vision for the Future of Washington Township Schools





## Possible Project Scope for Construction Referendum

**Estimated Tax Rate \$0.28 (per \$100) = \$185 million**

### Elementary – 8 Schools

#### Example Project Scope:

- Major renovation to 6 schools
- Brand new construction to 1 school
- Re-open 1 school as new construction
- All Buildings (8) – Secure entry and administration area
- All Buildings (8) – New fire alarm & PA system
- All Buildings (8) – ADA improvements
- Renovate academic spaces as needed (5 Buildings)
- Renovate wall and floor finishes (5 Buildings)
- Replace/upgrade mechanical, plumbing & electrical (5 Buildings)
- Create small group spaces (2 Buildings)
- Replace folding walls (2 Buildings)
- Replace roofs (2 Buildings)
- Add fire sprinkler system (2 Buildings)
- Redesign traffic pattern (2 Buildings)
- Replace exterior windows (1 Building)
- Add public restrooms (1 Building)
- Expand Cafeteria & gym (1 Building)
- Fence playground (1 Building)
- Add outdoor storage (1 Building)
- Add new control access doors – as needed

### Middle School – 3 Schools

#### Example Project Scope:

- All Buildings – Secure entry and administration area
- All Buildings – New fire alarm and PA system
- All Buildings – Add fire sprinkler system
- All Buildings – Replace/upgrade mechanical plumbing & electrical
- All Buildings – Renovate wall and floor finishes
- All Buildings – Replace gym bleachers
- Add classrooms (2 Buildings)
- Expand Cafeteria (2 Buildings)
- Redesign traffic pattern (2 Buildings)
- Add ramp to gym stage (1 Building)
- Replace exterior lighting (1 Building)

### High School – 1 School

#### Example Project Scope:

- Secure entry and administration area
- Improve and expand current security camera system
- Convert offices to classrooms
- Renovate Science labs
- Create second floor Learning Commons
- Renovate Information Center
- Expand Cafeteria
- Expand Dean's Office
- Replace corridor carpeting and remove wall carpet
- Replace four (4) boilers
- Demolish 1605 building and add parking
- Renovate Auditorium and Performing Arts spaces



## Possible Scope of Operating Referendum

**Estimated Tax Rate \$0.11 (per \$100) = \$6.5 Million**

### Current Staff

- Maintain all current staff
- Current community supported referendum of \$4 million per year (voted on in 2010) ends in 2017 and pays for staff at all levels

### New Elementary Staff

- Subside overcrowding in current 7 elementary schools
- Allow staffing of the 8<sup>th</sup> elementary school
  - Administration
  - Office Staff
  - Support Staff
  - Custodial Staff
  - Special Area Teachers

### New Support Staff

- Add a few teachers and support positions to address current needs in the district



**State mandated  
funding changes in  
2008-2009 for public  
schools**

## **CHANGES IN FUNDING**

**Results in a required  
referendum by voters  
to seek additional  
investments in school  
facilities and  
operations**



**M.S.D. OF WASHINGTON TOWNSHIP**  
**COMPARISON OF 2016 CERTIFIED TOTAL TAX RATES**  
*Selected Nearby Schools*

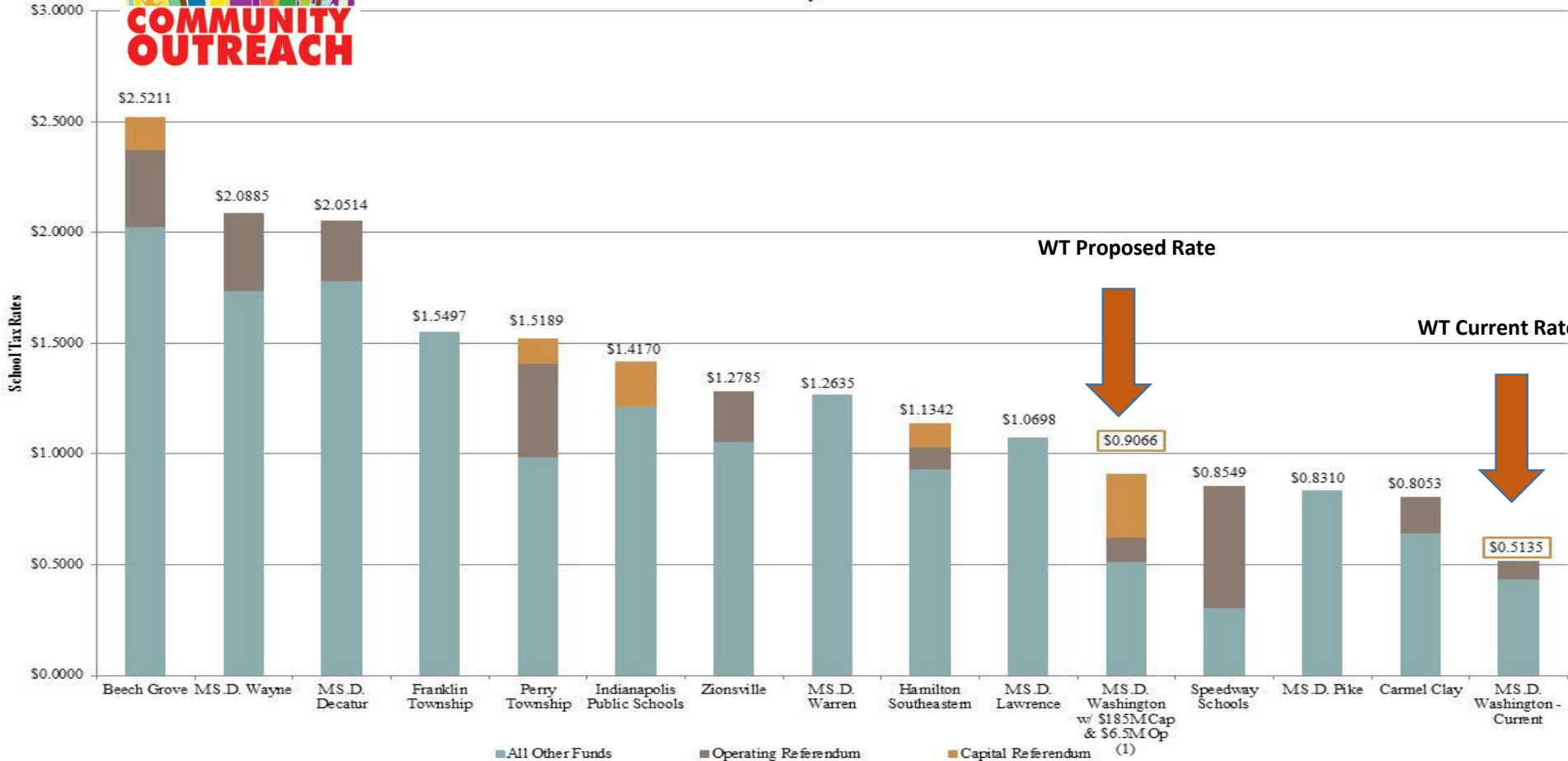

(1) Assumes \$185M capital and \$6.5M operating referenda with an estimated combined impact of \$0.3931.

Note: Based upon information provided by the DLGF. Tax rates may change to the extent the DLGF amends the pay 2016 budget orders.





**Monthly Taxpayer Impact**  
**\$185,000,000 Various Construction Projects**  
**\$6,500,000 Operating**

Market Value of Home	Net Assessed Value	<u>Construction</u>	<u>Operating</u>	<u>Total</u>
\$75,000	\$16,500	\$3.89	\$1.52	\$5.41
100,000	32,750	7.72	3.01	10.73
125,000	49,000	11.55	4.50	16.05
150,000	65,250	15.38	6.00	21.38
<b>173,200 (1)</b>	<b>80,330</b>	<b>18.93</b>	<b>7.38</b>	<b>26.31</b>
200,000	97,750	23.04	8.99	32.03
222,737	112,529	26.52	10.34	36.86
250,000	130,250	30.70	11.97	42.67
300,000	162,750	38.36	14.96	53.32
400,000	227,750	53.67	20.93	74.60
500,000	292,750	68.99	26.91	95.90
750,000	465,750	109.76	42.81	152.57
1,000,000	653,250	153.95	60.04	213.99

(1) Median Home Price in Washington Township



# District implications if the community doesn't support the referenda

## **No Operating Referendum Implications District-Wide:**

- Significant increase in class size
- Unable to staff an 8<sup>th</sup> elementary school
- Reduction of staff at all schools
- Termination of academic and support programs
- Decrease in ability to recruit and retain outstanding staff & new families
- Negative impact to home sales in Washington Township

## **No Construction Referendum Implications District-Wide:**

- Overcrowding continues in schools
- Increase in trailers at all schools
- Deteriorating school facilities
- Continued failing systems
- Safety & security concerns
- Negative impact to property values and unable to protect community investment
- Unable to open 8<sup>th</sup> elementary school



# John Strange implications if the community doesn't support the referendum

## **No Operating Referendum Implications for John Strange:**

- Significant increase in class size
- Reduction of staff
- Termination of academic and support programs
- Decrease in ability to recruit and retain outstanding staff & new families
- Negative impact to home sales in Washington Township

## **No Construction Referendum Implications for John Strange:**

- Overcrowding continues
- Increase in trailers
- Deteriorating school facilities
- Continued failing systems
- Safety & security concerns
- Negative impact to property values and unable to protect community investment
- Continued traffic flow safety concerns



## A Proposed Project that Protects Taxpayer Investment and Property Value

- ✓ An extensive review process to reduce costs and maximize benefits
- ✓ A commitment to address the needs of this and future generations
- ✓ <sup>Tony</sup> The active involvement of residents, parents, educators and classroom leaders in the design
- ✓ Maintain & increase property values
- ✓ Review of facility improvement options by a community-based Master Facilities Committee



# Referendum Process

**June 8<sup>th</sup>** WT School Board Referendum Hearing

**November 8<sup>th</sup>** WT Community Vote

*Referendum questions will is designed to allow maximum flexibility and continued community input to shape the future of our schools.*

**What does the proposal mean  
specifically for  
John Strange Elementary School?**





## John Strange Elementary School

---

**Sq. Ft.: 68,917    Acres: 9.63 + 2.16**

**Grades: K-5    Enrollment 2006-07: 395**

**Enrollment 2015-16: 633**

---

### Construction History

<b>1924 -1977</b>	Previous Building
<b>1977</b>	Original Construction
<b>1987</b>	Remodeling
<b>1992</b>	Re-Roofing
<b>1998</b>	Electrical Upgrade
<b>1999</b>	Running Track, ADA Access
<b>2000</b>	Reception Renovation
<b>2001</b>	Cafeteria Floor
<b>2004</b>	Interior Finishes/Parking Lot
<b>2009</b>	Added 2 Trailers to the Existing 2 Trailer
<b>2010</b>	New Boilers/Chillers
<b>2015</b>	Added 2 Trailers to the existing 4 Trailers (currently 6 trailers)





# John Strange Elementary School Facility Needs

## Master Facilities Committee Discussions 2015-2016

### Area #1: Capacity/Educational Adequacy

- Building is overcrowded and all spaces are used as classrooms
- There are currently six trailers to accommodate enrollment
- Rooms once used for support services have been converted to classrooms
- No Large Group Instruction room
- No lab or project area
- Limited small group space in cubby area
- Walls between rooms are not permanent, causing many acoustical issues
- Cafeteria too small for enrollment with cramped serving line area
- The clinic is too small – only two beds, one toilet and no privacy areas
- Stage is adequate, but there is no handicapped accessibility to stage
- One counseling office in the back of the stage with no handicapped access
- Two small conference rooms, neither will accommodate a large case conference or meeting
- No individual timeout space for students
- Most furniture is standard with little flexibility
- Educational technology improvements are needed

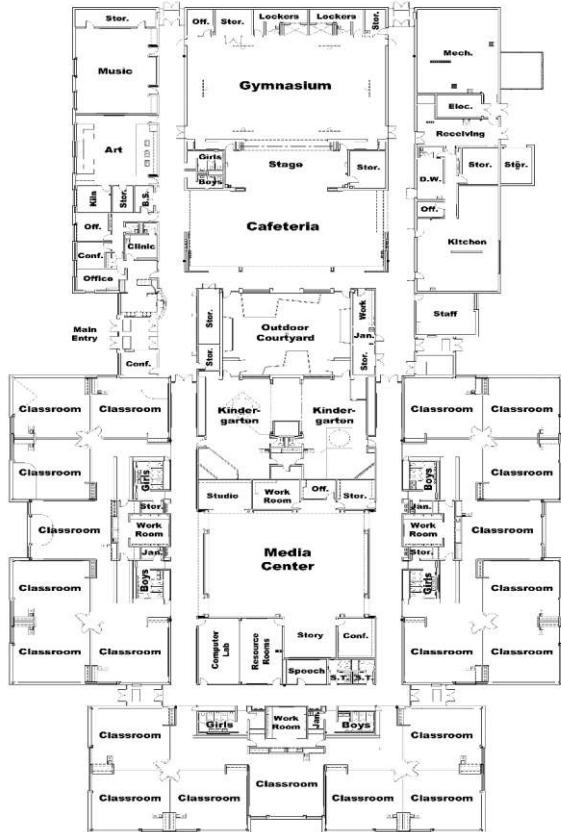





# John Strange Elementary School Facility Needs

## Master Facilities Committee Discussions in November 2015

### Area #2: Safety Security and Code Compliance

- Buzzer system entry – vestibule is not secured
- No security cameras
- PA system is inadequate
- No sprinkler system
- Traffic flow is a huge problem as is having a safe place for students waiting to be picked up (car rider line safety in parking lot)
- Handicap accessibility improvements are needed
- Configuration of cubby areas outside classrooms limits visibility needed for supervision
- Cafeteria – No separation between serving lines and kitchen

### Area #3: Healthy Learning Environment

- Roof needs to be replaced (last time it was replaced was in 1992)
- Temperatures are uneven throughout the building
- Boxes and air handlers need to be replaced
- Upgrade interior and exterior lighting
- Carpet and vinyl wall covering needs to be replaced
- Technology infrastructure upgrades are needed

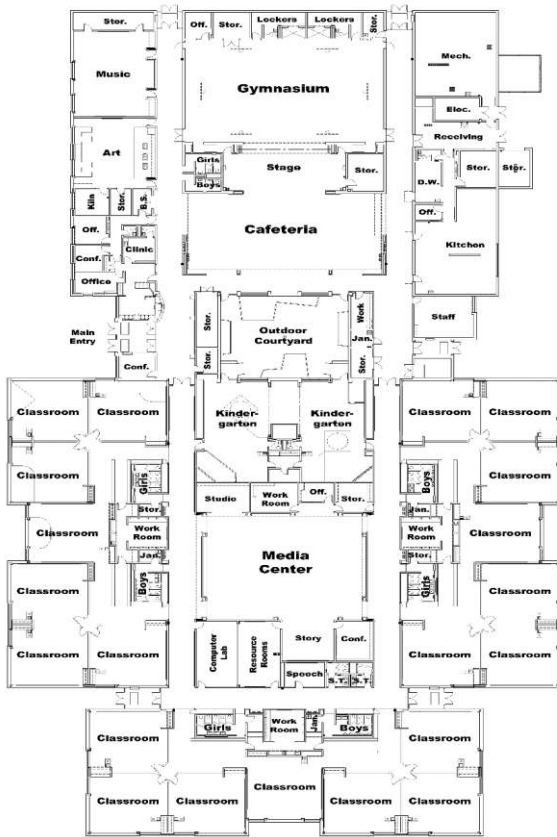



## District Wide Guiding Principles – For the future of all WT Elementary Schools

### Capacity/Educational Adequacy

- K-5 Buildings – Consistency, Less transitions between grades
- 650 – 725 Optimal Enrollment Capacity

### Healthy Learning Environment

- Space for whole group, small group, interventions near the classroom, & large group instruction areas
- Space for support services – OT/PT therapy, individualized instruction, handicap accessibility, English as New Language services, counseling, clinic, special education
- Flexible furniture to increase student collaboration spaces – inquiry, personal experiences
- Staff collaboration spaces – work areas for discussion, planning, and reflection
- Instructional technology and infrastructure improvements

### Safety/Security & Code Compliance

- Secured entrances & security cameras
- Handicap accessibility
- Traffic flow and parking improvements
- Sprinkler systems

# Solutions & Feedback





# Summary of Eastside Elementary Issues to Solve

(Guiding principles for any possible solutions)

- Additional space for elementary students on the eastside of the district
- Create K-5 inclusive elementary schools (to limit student transitions between buildings when switching grades)
- Address renovation needs
- Remove trailers
- Improve traffic flow for residents and students
- Balance limited operating funds between fewer classroom teachers or additional staff needed for third Eastside elementary



# Master Facility Planning Committee

## Option 1:

### Enlarge John Strange School 2019-20

- Minimal changes to John Strange community
- More expensive than a new school to build a second story
- SAFETY CONCERN - Expanding capacity would make current traffic flow and parking issues significantly worse
- Smallest elementary site with only 11 acres limits expansion options
- Minimal support to allow kindergarten back at Allisonville
- Other schools would have to be larger to accommodate needed capacity
- Trailers would be removed

#### **Est. Taxpayer Investment**

- \$18,707,000 - Enlarge JS on 1<sup>st</sup> floor only and add capacity needed at other schools
- \$23,850,000 - Enlarge JS with a 2<sup>nd</sup> floor



# Master Facility Planning Committee

## Option 2:

### Enlarge Allisonville School 2019-20

- Allisonville student population would be at 950-1000 students
- Minimal changes to John Strange community
- John Strange would remain same size – trailers would remain
- SAFETY CONCERN: significant traffic flow and parking concerns would exist
- Additional staff reoccurring costs for an elementary this large
- Major construction while students are present

#### **Est. Taxpayer Investment**

- \$6,000,000 – ADDITIONAL cost to the currently needed renovations for AV at \$7,736,000 (Total of \$13,736,000 for AV)
- \$11,000,000 – Renovations needed to JS (same size)
- \$450,000 – ADDITIONAL annual cost to staff an elementary school this large at AV

# Master Facility Planning Committee

## Option 3:

### New Elementary School at Wyandotte 2019-20



- New buildings are more efficient to operate and staff
- Traffic flow and parking issues solved (29 acres at WY)
- Able to maintain all current community athletic fields without disruption
- Efficient use of taxpayer dollars for 725 student capacity new elementary school
- Able to have fewer student transitions at all elementary schools (K-5)
- Repurpose John Strange for other educational services such as preschool
- Faster and more economical construction without students
- John Strange community would have to go to a different site for elementary school (distance WY to JS is 2.8 miles)

#### **Est. Taxpayer Investment:**

- \$22,850,000 – New elementary school at WY site *(Needed renovations at WY to make an elementary school would equal 79% toward the cost of new construction at \$18,163,000)*
- \$2,000,000-\$3,000,000 – Renovations to JS to repurpose for other educational services *(in addition to the CPF currently projected to support current preschool facility needs at \$3,410,000)*



## Recommended by the Master Facilities Committee

### Option 3

Replace Wyandotte with a new & larger 725 student elementary school building and repurpose John Strange facility for educational services

Minimum of three years away  
2019-2020

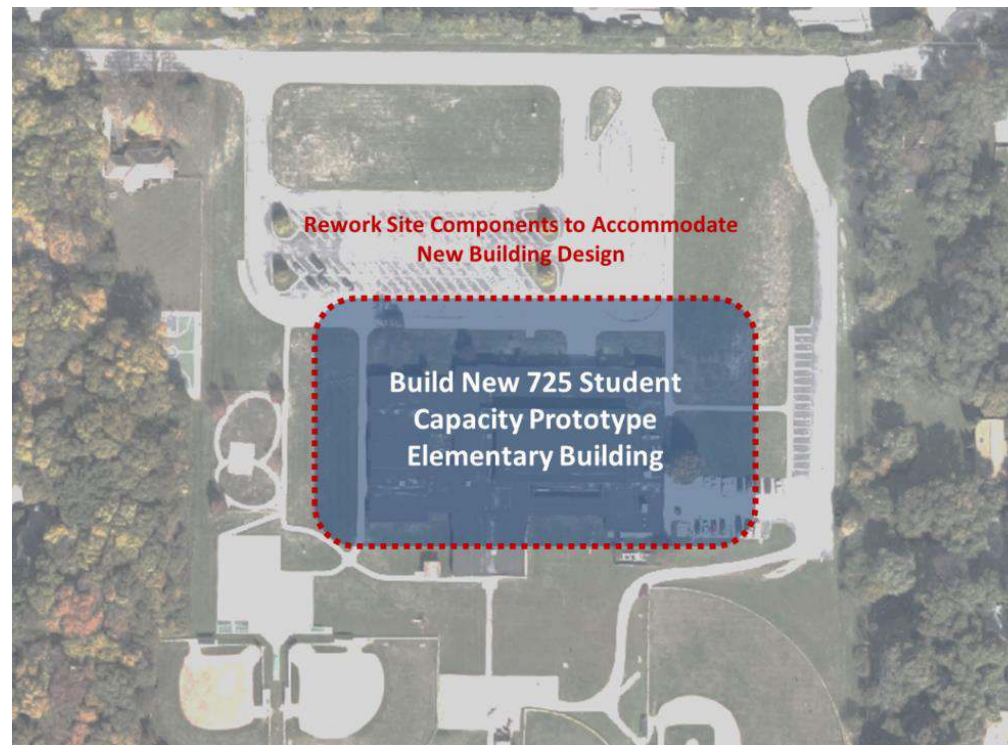





# Other Benefits of Relocating John Strange Elementary

## Option 3

### Capacity/Educational Effectiveness

- Solves capacity issues on eastside
- Both schools able to accommodate K-5
- New school design can better support and respond to the requirements of today's learning environment and teaching methods

### Healthy Learning Environment

- Constructing a new building is a fast and cost effective solution compared to renovating and resolving the many facility needs at John Strange Elementary School and Wyandotte
- Students would not be subjected to renovations and the disruptions that renovations may cause to the learning process

### Safety and Security

- New building allows opportunity to have a fully code compliant, safe and secure facility
- Wyandotte site is considerably larger with 29 acres as compared to John Strange's 11 acres

### Technology

- Replacement facility would have new technology infrastructure, equipment and classroom technology



# What happens to the John Strange Elementary School site with **Option 3**?

If this option moves forward the district is committed to repurposing John Strange for future educational services. Several options are currently being studied. It would be a **minimum of three years** before students could move to the new facility at Wyandotte.

## Main Potential Options

- Special Education Preschool
- Staff Preschool
- Community Preschool
- School site for staging during construction

## Additional Potential Options

- Advancement & Alumni Center
- Adult & Community Education Classes
- District Division/Services
- Professional Development Spaces for Teachers

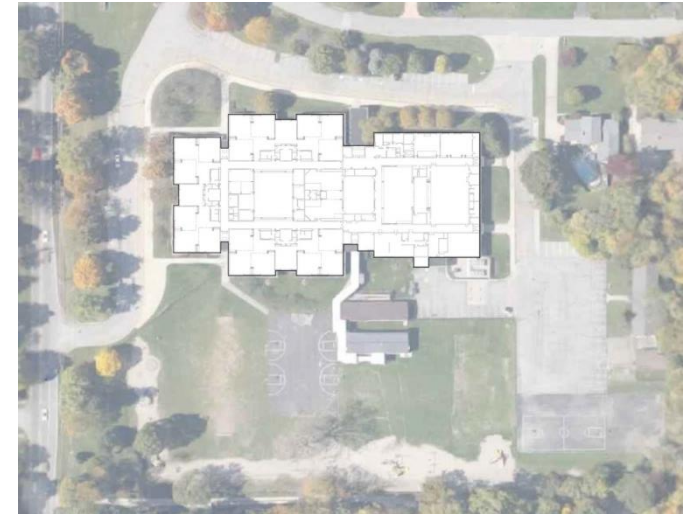



## Option 4:



### Guidelines for Solutions:

- Creates additional space for elementary students on the eastside of the district but only able to maintain 2 elementary school sites
- Creates K-5 inclusive elementary schools
- Address renovation needs
- Remove trailers
- Improve safety with better traffic flow
- Does not add significant staff/operating costs due to a significant increase to taxpayers





# Next Steps:

- *Feedback & Tour tonight*
- Complete and leave the yellow “Feedback Form”
  - *Additional follow-up for specific questions*
  - *Optional additional community meeting*
  - *Tour sign-up of Liberty Park Elementary on May 25<sup>th</sup>*
  - *Continue to stay involved*



## Table Discussion...

### All Voices Heard in Small Groups

1. Give feedback on the 3 options reviewed by the Master Facility Committee.
2. What is an additional 4<sup>th</sup> option the district should consider?
3. Additional considerations you want the district to keep in mind...

\*\*\*Complete the yellow feedback form and leave it with your table facilitator.\*\*\*

**John Strange Facility Tour**

